

HOW TO GUIDE

First Steps for Video Recording

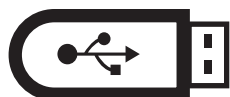

The following pages address the first steps in setup of the video recording room. Please take note of the USB requirements, and the removal of a USB drive.



USB Drive Format

FAT32 format
8 gigabyte minimum
Preferably Clean Drive (free from other documents)

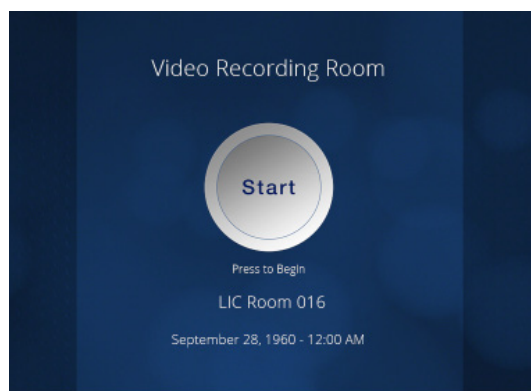

Press 'Start' to access room modes.

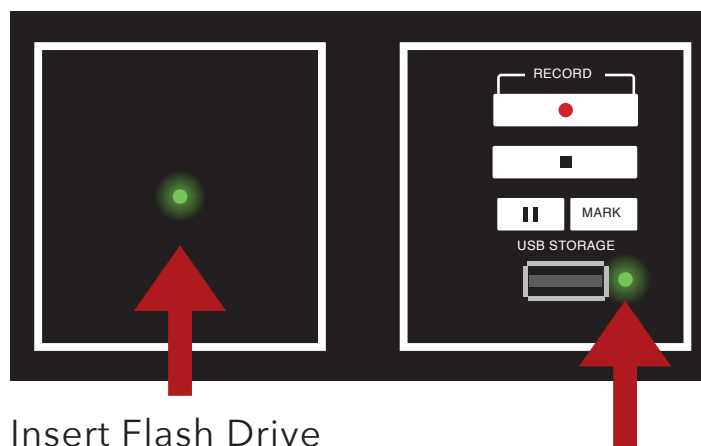

Insert Flash Drive
Wait for Solid Green Light
Press Record when ready

 **NEED HELP**
Ask for assistance at the Tech Desk

HOW TO GUIDE

Floor Tape for Bounding Box and Green Screen



Below are descriptions for the floor tape.



This tape represents the **bounding box**. The camera view is within this frame.

When in Green Screen mode, stand in the larger rectangle to eliminate shadows from casting on the screen.



HOW TO GUIDE

Camera View Display



Check the display in front of the control center for current camera view.



HOW TO GUIDE

Insert and Removal of Flash Drive



Pay attention to prompts from the control interface.



Yellow means that the recording is finalizing. **DO NOT** remove USB during this time also.

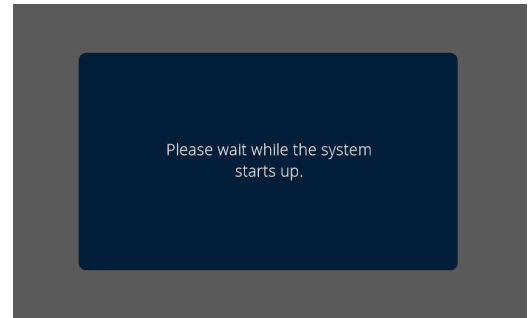

Please wait for the room to set up, and when switching through modes.

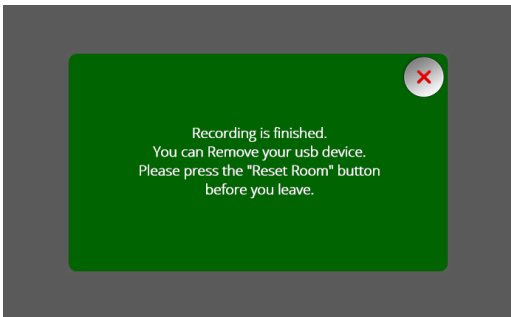

Green means recording is finished and it is safe to remove USB.

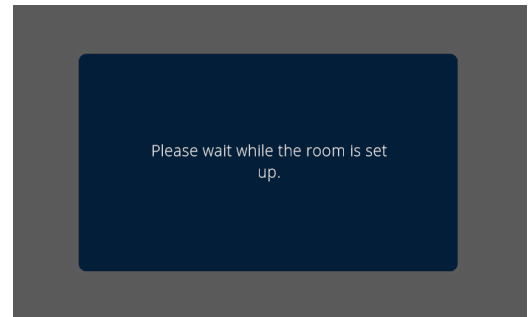

HOW TO GUIDE

Main Modes and Options



See Corresponding Page Number

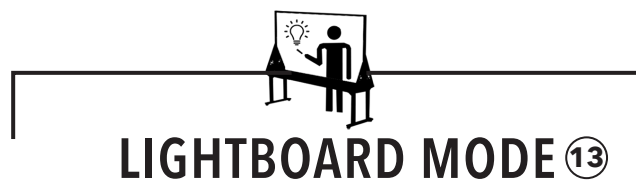
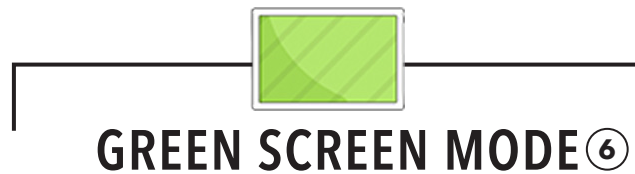
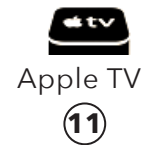
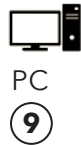
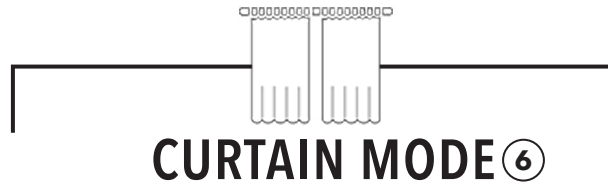

? **NEED HELP**
Ask for assistance at the Tech Desk

NOTE: Modes are highlighted green when selected



⑤

HOW TO GUIDE

Curtain Mode



The teleprompter is the sole option for Curtain Mode. The next page is a guide for teleprompter use. Check page 2 for floor tape descriptions.



RESET ROOM
when finished



HOW TO GUIDE

Teleprompter



Unlike other modes, the teleprompter can be selected in addition to other options such as PC or laptop use.

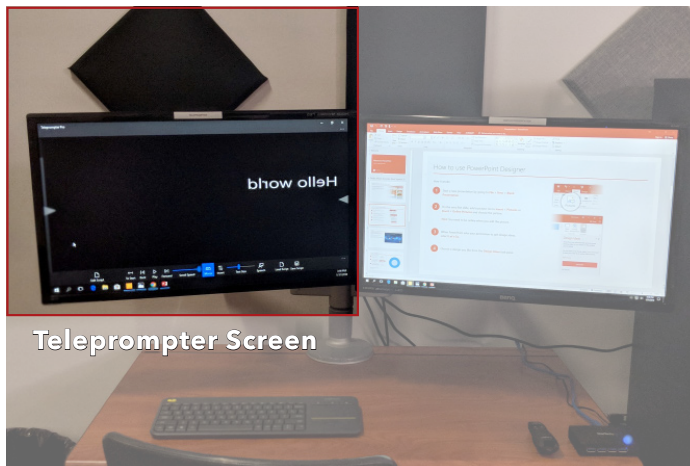

Left Screen of PC displays the teleprompter software.

Teleprompter Pro

HOW TO GUIDE

Display Mode



Display mode enables the television screen behind the curtain. Options are available for mirroring screens from a PC or laptop. Check page 2 for floor tape descriptions.



RESET ROOM
when finished



NOTE: Volume is preset to MUTE, but can be changed within the control interface.

HOW TO GUIDE

PC



The PC has dual monitors. The left is designated to the teleprompter software, while the right is a display or for presentations. The right will be mirrored on the screen in Display Mode.

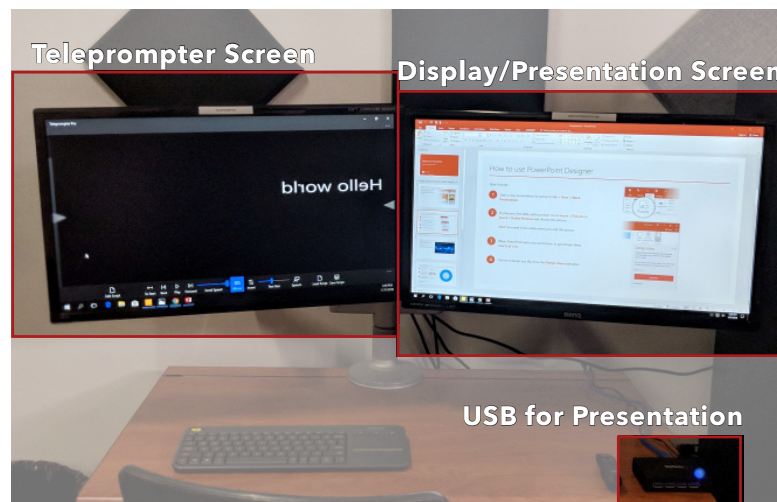

NOT FOR RECORDING
See page 1

Available USB Ports



Display Tip: Minimum font size should be 18pt for best visibility

HOW TO GUIDE

Laptop



A personal laptop can be used within display mode to mirror screens for presentations. The podium has preexisting outlets and HDMI cable. Select adapters are available in a drawer by the control interface.

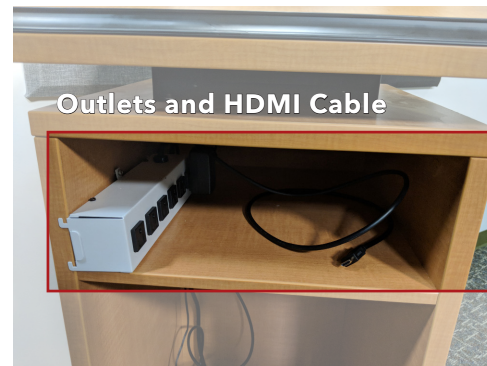

Outlets and HDMI Cable



HDMI Cable

NOTE: The Technology Checkout Desk has laptops available for checkout.



Location of HDMI adapters

HOW TO GUIDE

Green Screen Mode



Green Screen mode enables the projection screen with a field of green. Check page 2 for floor tape descriptions.



RESET ROOM
when finished



NOTE: Please allow time for the screen to process and completely fill.